

# 3-4V



## FLANGED MULTI-WAY VALVE

### DESCRIPTION

- Flanged 3-way and 4-way diverter valve at 90°.
- Monoblock cast iron body with bolted bonnet.
- Multiple body and diverter materials available.
- Face-to-face distance in accordance with **CMO Valves** standard.

### GENERAL APPLICATIONS

This valve is suitable for liquids with dry matter content, products with a concentration of 4% and over. It is specially designed to handle pulp, and is used in applications such as:

Designed for applications such as:

- Paper industry
- Chemical plants

### SIZES

DN80 to DN300

*\* Other DNs on request.*

### WORKING PRESSURE ( $\Delta P$ )

DN80 - DN150	10 bar
DN200	8 bar
DN250 - DN300	6 bar
DN350 - DN400	5 bar

*\* Other pressures on request.*

### FLANGE DRILLING

PN10 & ASME B16.5 (Class 150)

### OTHER OPTIONAL FLANGE DRILLING

- PN 6
- PN 16
- PN 25
- Australian Standard
- British Standard
- JIS standard



Fig. 1

### APPLICATION OF EUROPEAN DIRECTIVES

See the applicable directives document for **CMO Valves**.

*\*For information on categories and zones related to applications in potentially explosive atmospheres (ATEX), please contact the technical-commercial department at **CMO Valves**.*

### QUALITY DOSSIER

All valves are tested hydrostatically in accordance with **CMO Valves**, and material and test certificates can be provided.

- Body test = working pressure x 1.5.
- Seal test = working pressure x 1.1.

### 3V "L" TYPE

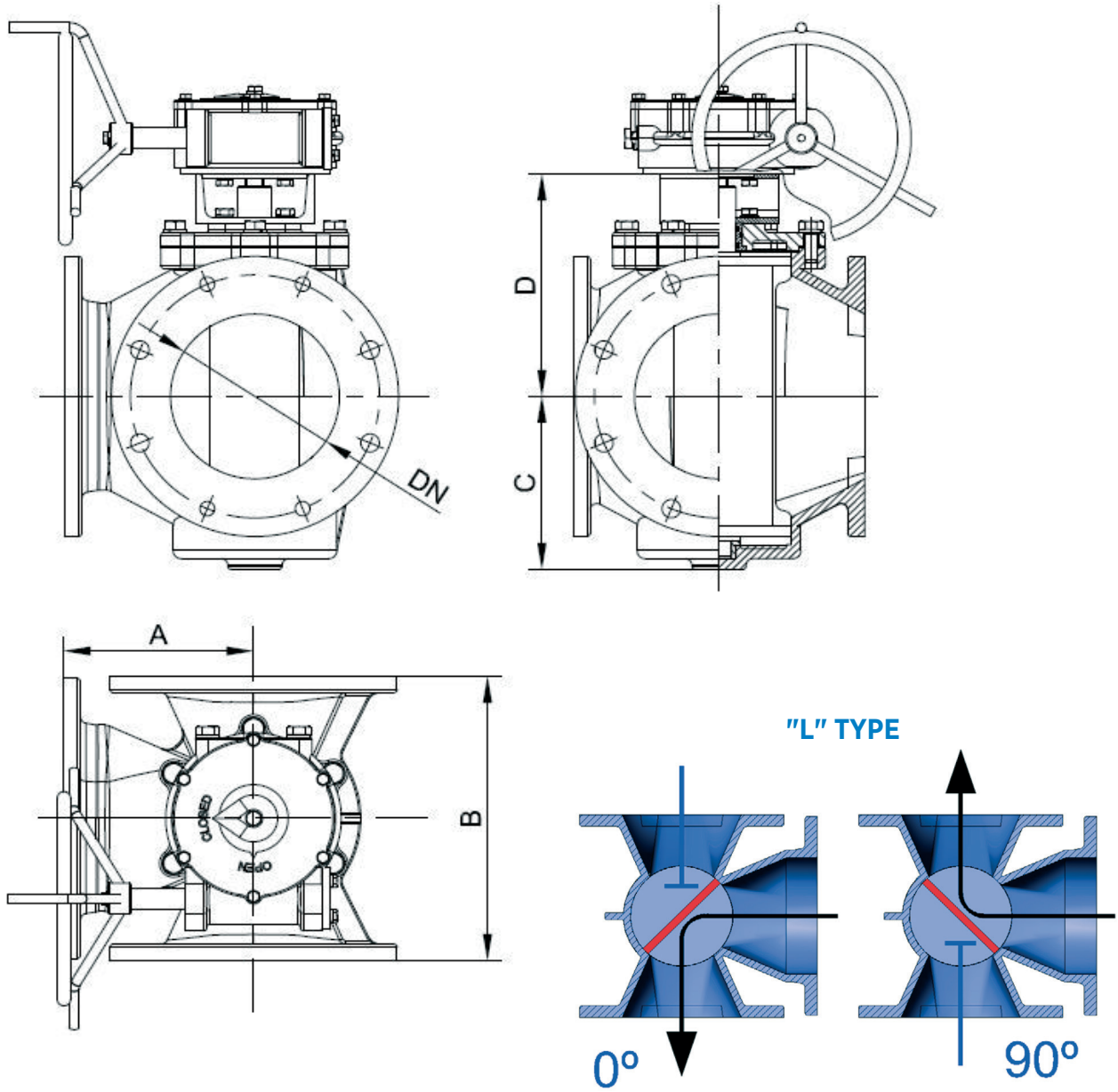

Fig. 2

DN	$\Delta P$ (bar)	A	B	C	D
80	10	137.5	200	128	193
100	10	162.5	250	128	193
125	10	200	290	145	210
150	10	200	290	171	231
200	8	225	345	210	269
250	6	272.5	415	257	328
300	6	287.5	470	294	358
350	5	317.5	530	343	404
400	5	360	610	375	449

Table. 1

### 3V "T" TYPE (SPECIAL)

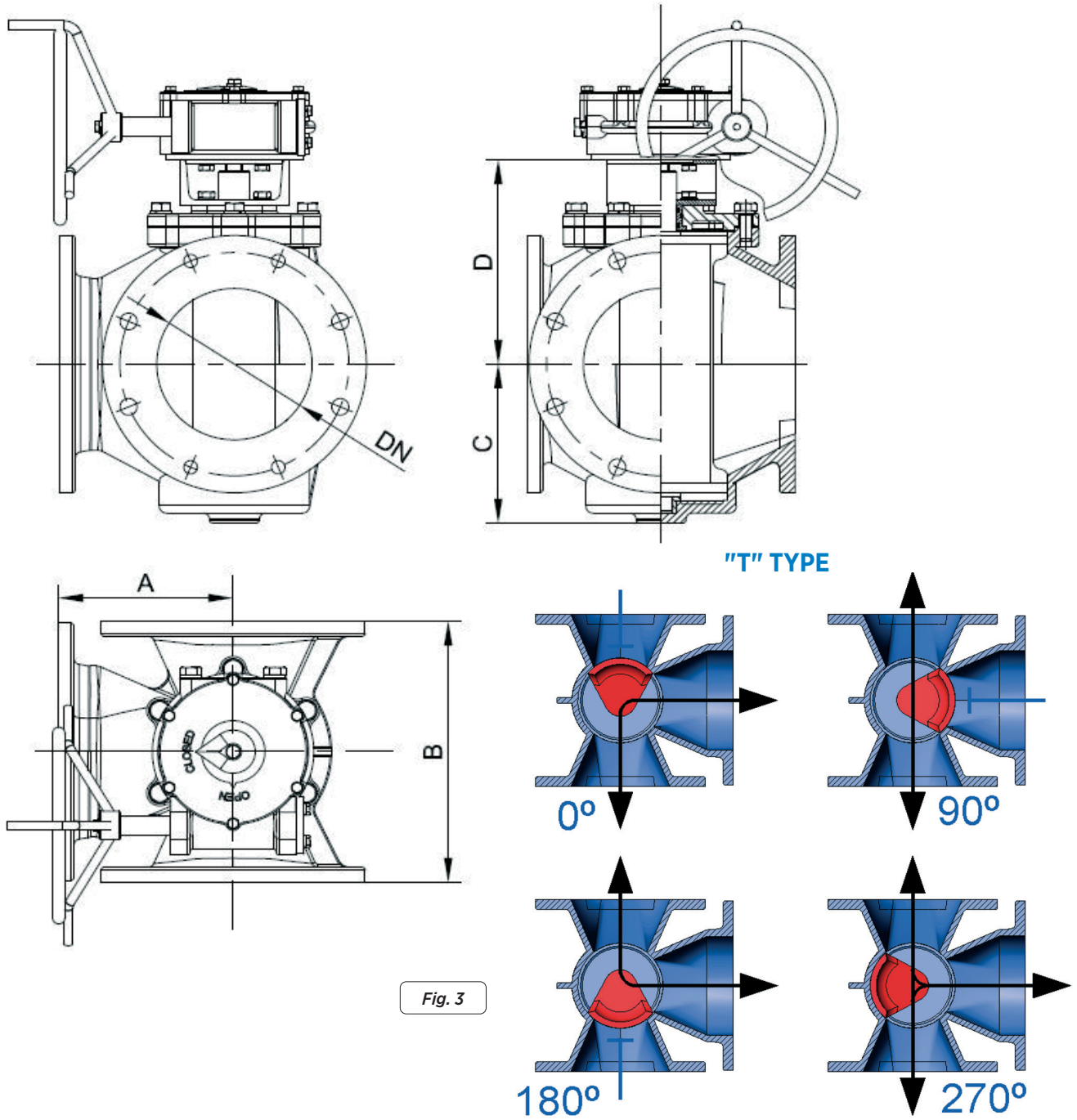

Fig. 3

DN	$\Delta P$ (bar)	A	B	C	D
80	10	137.5	200	128	193
100	10	162.5	250	128	193
125	10	200	290	145	210
150	10	200	290	171	231
200	8	225	345	210	269
250	6	272.5	415	257	328
300	6	287.5	470	294	358
350	5	317.5	530	343	404
400	5	360	610	375	449

Table. 2

## 4V "L" TYPE

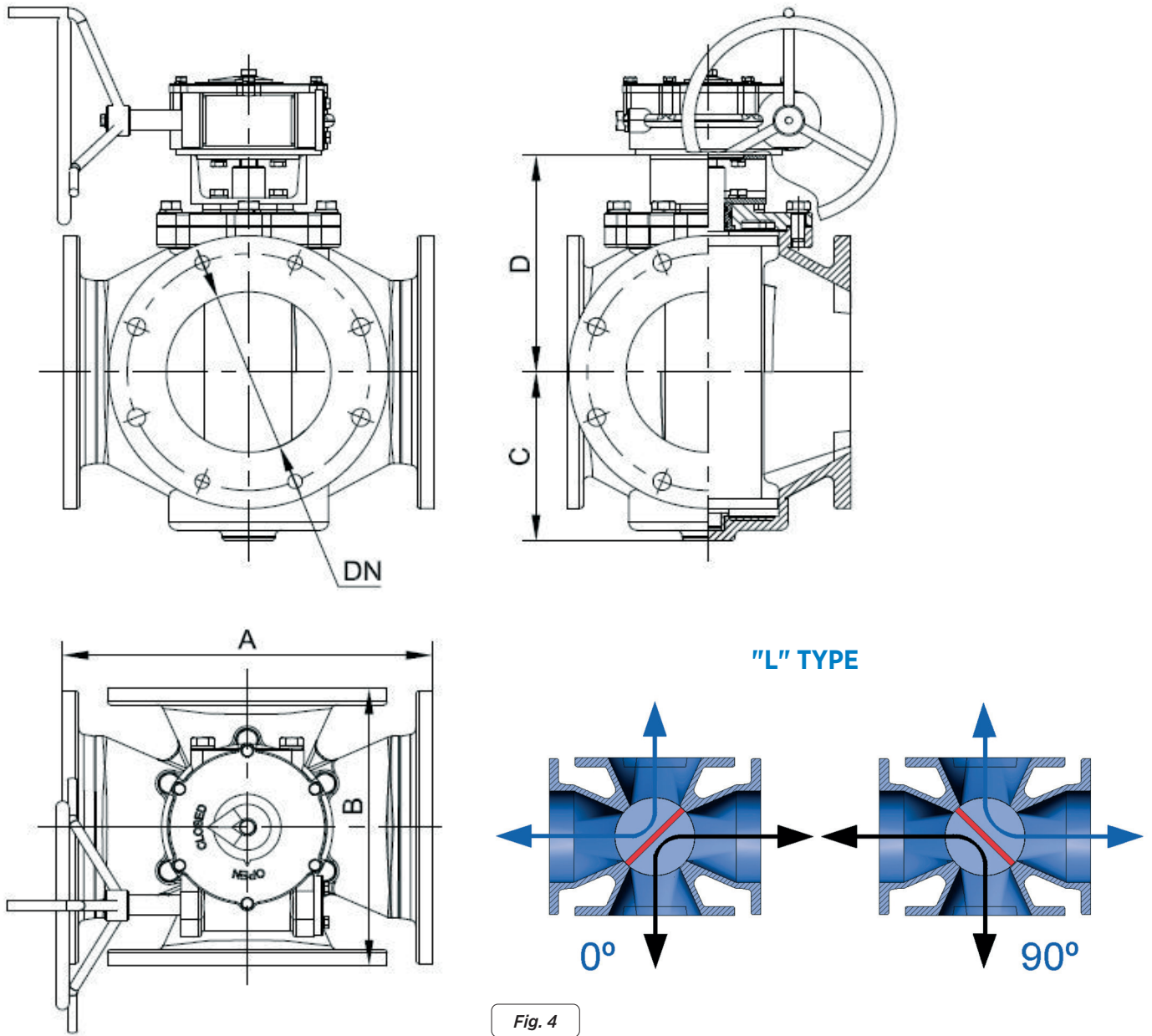

Fig. 4

DN	$\Delta P$ (bar)	A	B	C	D
80	10	275	200	128	193
100	10	325	250	128	193
125	10	400	290	145	210
150	10	400	290	171	231
200	8	450	345	210	269
250	6	545	415	257	328
300	6	575	470	294	358
350	5	635	530	343	404
400	5	720	610	375	449

Table. 3

## 4V "STRAIGHT THROUGH" TYPE

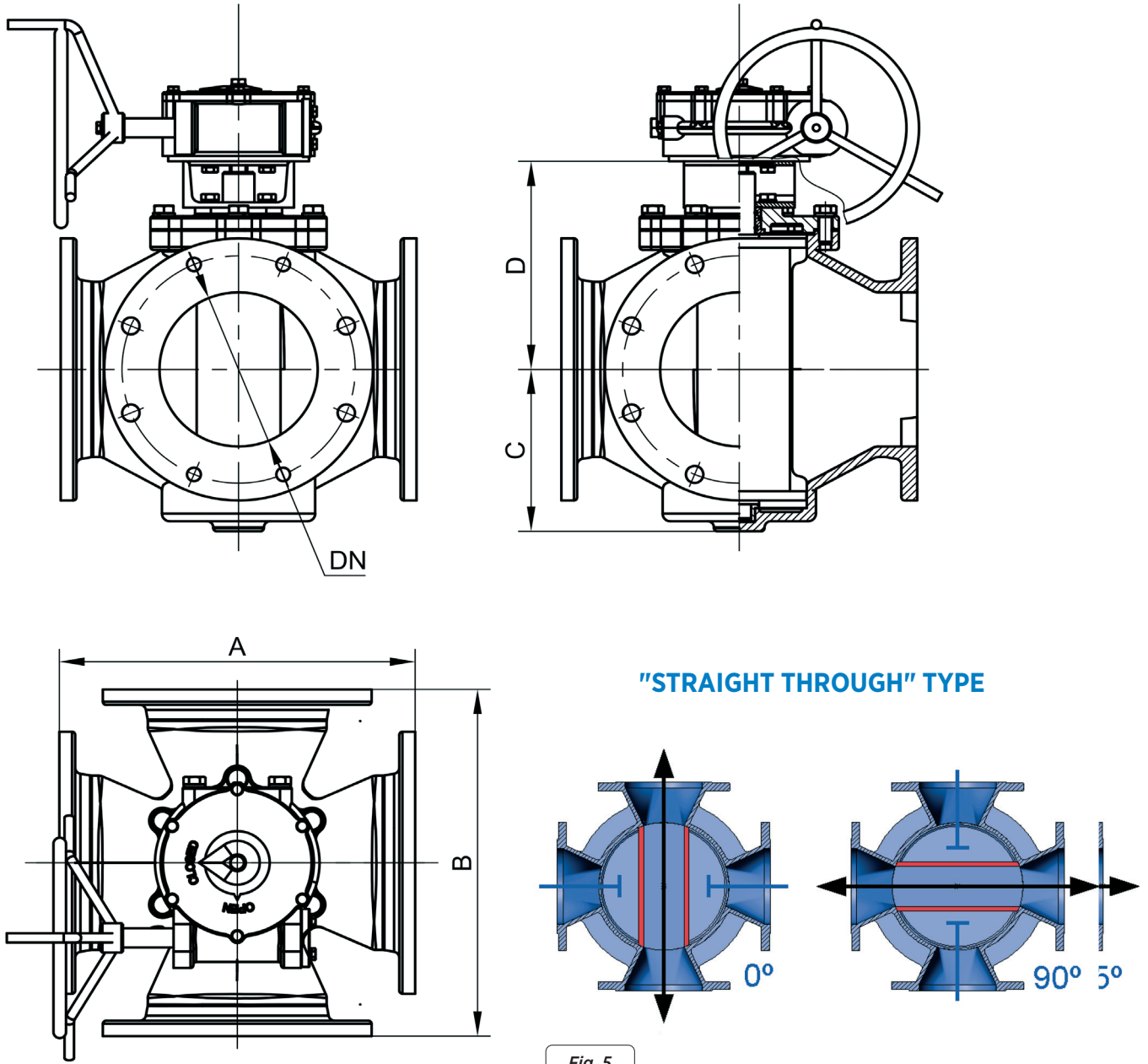

Fig. 5

DN	$\Delta P$ (bar)	A	B	C	D
80	10	440	370	128	193
100	10	440	370	169.1	193
125	10	440	370	169.1	210
150	10	440	370	169.1	231
200	8	550	550	210	269
250	6	550	550	210	328
300	6	550	550	210	358
350	5	550	550	210	404
400	5	550	550	210	449

Table. 4

## ACTUATORS

The drive enables operation of the multi-way valve. This is mounted on the valve body and transmits the operating torque to the distributor via the drive shaft. We offer a wide range of drives for our damper butterfly valves, all of which are interchangeable thanks to the design by **CMO Valves**. This design allows customers to easily change the drive themselves, and no additional assembly accessories are required. The overall dimensions of the damper butterfly valve may vary in accordance with the type of drive chosen.



ELECTRIC ACTUATOR

*Fig. 6*

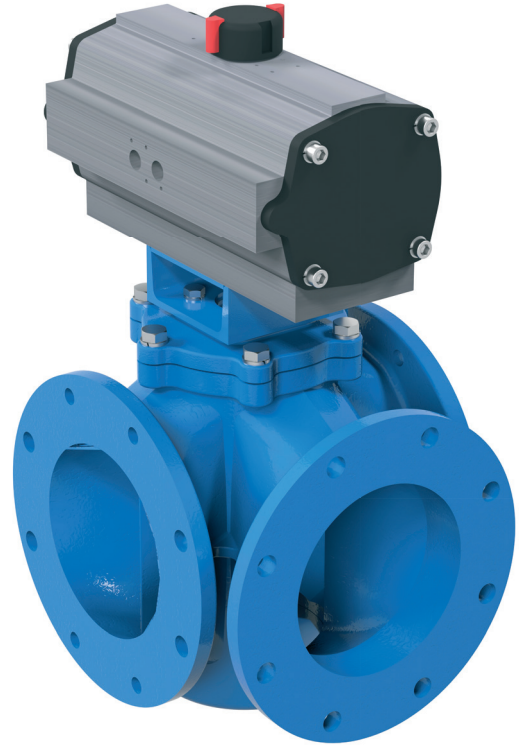

PNEUMATIC ACTUATOR

*Fig. 7*



HAND LEVER

*Fig. 8*



GEARED MOTOR ACTUATOR

*Fig. 9*

## FLANGE DIMENSIONS

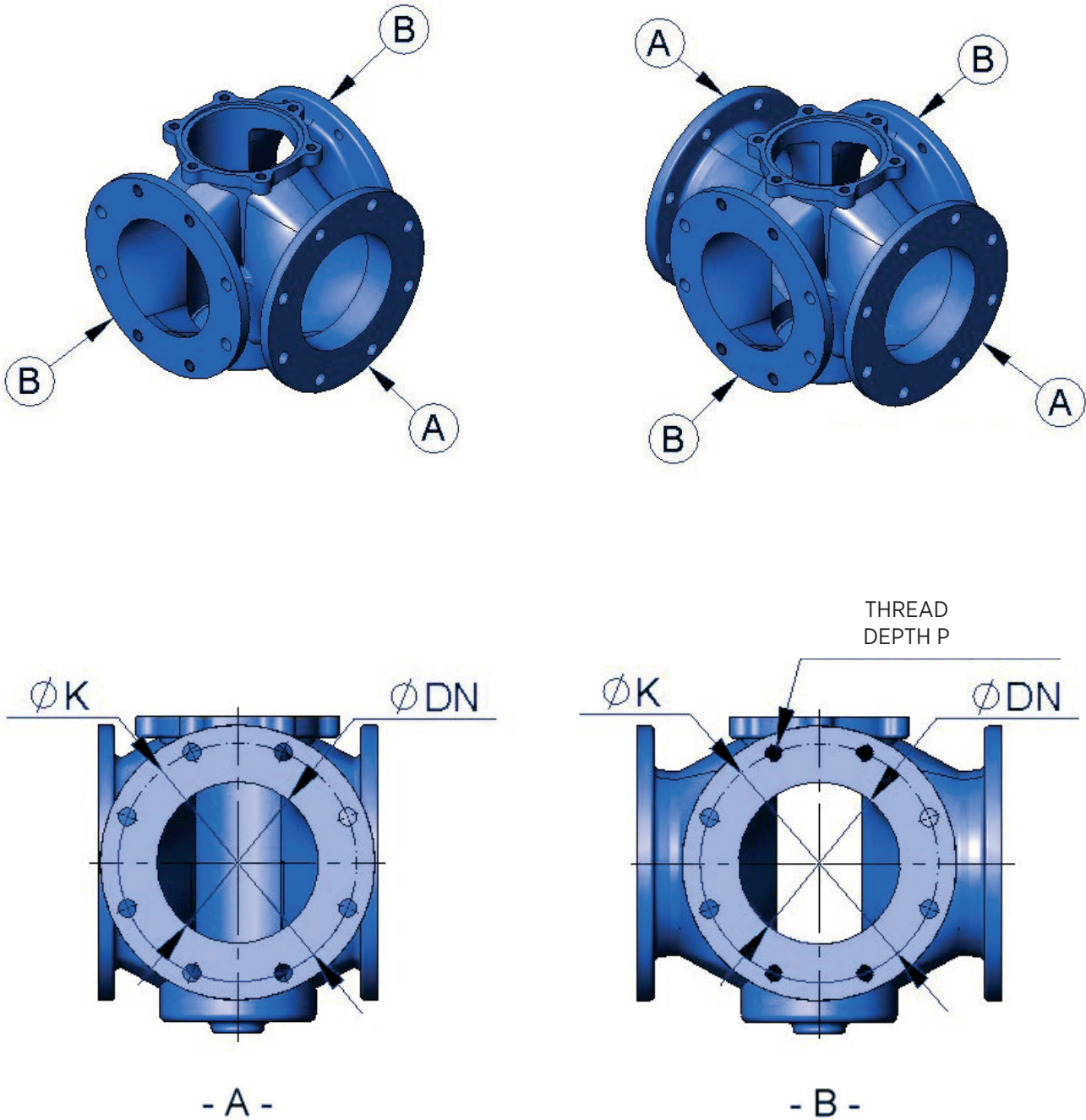

Fig. 10

EN 1092-2 PN10

DN	$\Delta P$ (bar)	A	B		M Metric	P (Depth)	$\varnothing K$
		○	●	○			
80	10	8	-	8	M 16	18	160
100	10	8	-	8	M 16	18	180
125	10	8	-	8	M 16	18	210
150	10	8	4	4	M 20	20	240
200	8	8	4	4	M 20	20	295
250	6	12	4	8	M 20	22	350
300	6	12	4	8	M 20	22	400
350	5	16	8	8	M 20	22	460
400	5	16	8	8	M 24	22	515

Table. 5

ASME B16, Class 150

DN	$\Delta P$ (bar)	A	B		R UNC	P (Depth)	$\varnothing K$
		○	●	○			
3"	10	4	-	4	5/8"	18	152.4
4"	10	8	-	8	5/8"	18	190.5
5"	10	8	-	8	3/4"	18	215.9
6"	10	8	4	4	3/4"	20	241.3
8"	8	8	4	4	3/4"	20	298.4
10"	6	12	4	8	7/8"	22	361.9
12"	6	12	4	8	7/8"	22	431.8
14"	5	12	4	8	1"	22	476.2
16"	5	16	8	8	1"	22	539.7

Table. 6

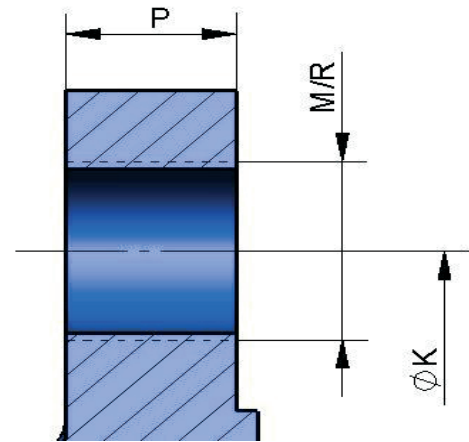

Fig. 11

- BLIND THREADED BORE
- THROUGH THREADED BORE

As part of its ongoing product and service improvement process, **CMO Valves** reserves the right to alter the data and content of this document at its discretion at any time without notice. The publication of the latest revision renders all previous documents invalid.

Installation and Maintenance Manual available at [www.cmovalves.com](http://www.cmovalves.com).





[www.cmovalves.com](http://www.cmovalves.com)



**CMO** VALVES

QMS CERTIFIED BY LRQA  
Approval number ISO9001 0035593

**CMO VALVES**  
**HEADQUARTERS MAIN**  
**OFFICES & FACTORY**

Amategi Aldea, 142  
20400 Tolosa  
Gipuzkoa (Spain)

Tel.: (+34) 943 67 33 99

[cmo@cmovalves.com](mailto:cmo@cmovalves.com)  
[www.cmovalves.com](http://www.cmovalves.com)

**CMO VALVES**  
**MADRID**

C/ Rumania, 5 - D5 (P.E. Inbisa)  
28802 Alcalá de Henares  
Madrid (Spain)

Tel.: (+34) 91 877 11 80

[cmomadrid@cmovalves.com](mailto:cmomadrid@cmovalves.com)  
[www.cmovalves.com](http://www.cmovalves.com)

**CMO VALVES**  
**FRANCE**

5 chemin de la Brocardière  
F-69570 DARDILLY  
France

Tel.: (+33) 4 72 18 94 44

[cmofrance@cmovalves.com](mailto:cmofrance@cmovalves.com)  
[www.cmovalves.com](http://www.cmovalves.com)